



Teaching & Learning SUMMIT



WEDNESDAY, FEBRUARY 5TH

AGENDA

Facilitated by: Georgia Department of Education

- | | |
|----------------------------|--|
| 8:30 AM- 9:00 AM | Registration |
| 9:00 AM - 9:15 AM | Welcome Laurie Allison, Northeast Georgia RESA Executive Director Tim Cochran, Pioneer RESA Executive Director |
| 9:15 AM - 9:45 AM | Georgia EdTALKS Dr. John Almarode: <i>Research to Reality: How Learning Works and What It Means for Our Schools and Classrooms</i> In the past two decades, the science of learning has uncovered key insights into how learning occurs. This EdTalk will present five essential principles that, when translated into classroom practices, can accelerate and enhance student learning. We'll explore practical strategies to help educators apply these principles and move student learning forward. |
| 9:45 AM - 10:15 AM | Expert Conversation <i>Let's Talk about How We Learn to Sharpen How We Teach</i> Hear from colleagues about how they are making the connections and bridging into everyday classroom instruction. |
| 10:15 AM - 10:30 AM | Break |
| 10:30 AM - 11:15 AM | Breakout Session I |
| 11:15 AM - 12:15 PM | Lunch Buffet served in the foyer with two serving lines. |
| 12:15 PM - 1:15 PM | Breakout Session II |
| 1:15 PM - 1:30 PM | Break |
| 1:30 PM - 2:30 PM | Breakout Session III |

ROOM LOCATIONS

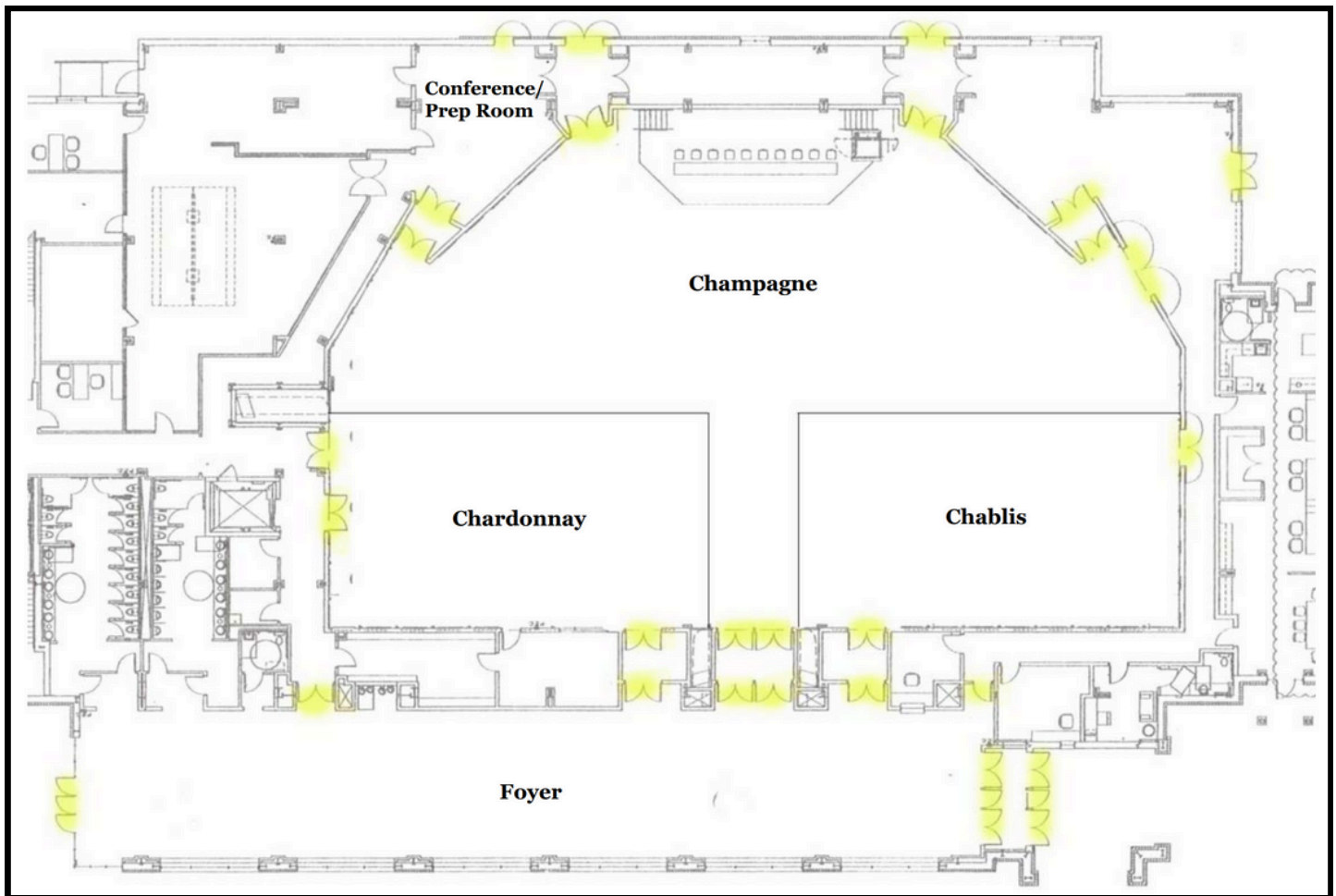

INTERNET ACCESS

Username: bbcgust

Password: BraseltonEvents2022#

BREAKOUT SESSION INFORMATION

Breakout Session 1
10:30 AM - 11:15 AM

Bridging Evidence-based Practices into Instruction

Participants will engage in collaborative conversation with other colleagues to discuss and develop a deeper understanding of the five essential principles and how they can be used to move student learning forward.

Participants will divide into three rooms based on the colored sticker on their name tag:

- Yellow: Champagne Room
- Blue: Chardonnay Room
- Red: Chablis Room

BREAKOUT SESSION INFORMATION

Breakout Session II

12:15 PM - 1:15 PM

Conference/Prep Room

Personalizing Learning that Meets the Needs of Students with Disabilities

Facilitators: Jenise Sexton & Alecia Segursky

Discover how to create personalized learning experiences that celebrate the unique assets of students with disabilities while fostering student-centered instruction. This session explores strategies for leveraging student strengths, designing inclusive activities, and implementing tools to empower students as active participants in their own learning journey. Learn practical ways to differentiate instruction and build an environment where every learner thrives.

Chardonnay Room

Maximizing and Growing CTAE Opportunities for Students

Facilitator: Jennifer Phinney

The mission of Georgia Career, Technical, and Agricultural Education (CTAE) is to provide students with high-quality educational programs, career pathways, and experiences that prepare them for workplace success. CTAE plays a critical role in supporting economic development in the state of Georgia by addressing the top site selection factor – a skilled workforce. Become acquainted with the five-year Strategic Plan for Georgia CTAE, an overview of Georgia CTAE, career clusters, career pathways, and the CTAE+ initiative.

Champagne Room

GaMTSS: An Integrated Approach to School Safety

Facilitators: Ben Moore & Aaron Morandini

In today's educational landscape, ensuring the safety and well-being of students and staff is paramount. School safety encompasses more than just physical security; it requires a proactive and comprehensive approach. Participants will explore best practices and key strategies for creating a secure and supportive environment where students can thrive academically and socially. Join us to learn how to foster a safe and nurturing learning environment for all students and staff.

Chablis Room

REI: Meeting the Needs of Rural Educators

Facilitator: Heather Finley

There are 115 rural school districts in Georgia, and all the students, teachers, and leaders in those districts deserve a great educational experience. Come learn about the service and support provided by the Office of Rural Education and Innovation (REI) at the Georgia Department of Education. The “small but mighty” team serves districts in the areas of instruction, technology, teacher recruitment and retention, college and career readiness, leadership, and support for completion schools. The team is a connector between the rural districts and GaDOE as well as between rural districts, sharing best practices, professional learning, and resources. Come join us!

BREAKOUT SESSION INFORMATION

Breakout Session III

1:30 PM - 2:30 PM

Conference/Prep Room

Personalizing Learning to Meet the Needs of EL Students

Facilitators: Noel Wilkinson & Asha Jassani

Discover how personalized learning can unlock the potential of English learners (ELs) by celebrating their unique strengths and fostering growth in both language proficiency and academic achievement. In this interactive session, school and district leaders will explore practical strategies to guide their teams in designing personalized learning experiences grounded in an asset-based approach and a growth and mastery mindset tailored to EL students. Participants will: (1) Analyze demographic, linguistic, and academic data to uncover the diverse assets of the EL students in their schools and district; (2) Engage in collaborative discussions to examine the transformative role of a growth and mastery mindset to foster EL student success in attaining English language proficiency and meeting academic achievement standards; and (3) Develop actionable steps to address challenges and empower teachers to create learning environments that leverage students' connections and representation. Leave equipped with tools, strategies, and leadership insights to drive meaningful changes that help every EL student thrive in a personalized learning environment. Transform your schools and classrooms into spaces where EL students achieve academic English language proficiency while feeling seen, valued, and inspired to succeed.

Chardonnay Room

Making GA the Best Place to Teach, Starting with your Community

Facilitators: Amber Loughridge & Dan McGuire

This session explores how educators, leaders, and stakeholders can leverage resources from the GaDOE's Educator Support and Development Division to create thriving teaching environments. Participants will learn actionable strategies for supporting teacher recruitment and retention, fostering well-being, enhancing professional growth, and building strong community partnerships.

Chablis Room

GaMTSS: A Whole Child Approach to Improving Attendance

Facilitators: Lindsay Oliver & Ben Moore

This session will define chronic absenteeism and its impact on student outcomes, identify common barriers to attendance, and explore effective strategies to improve attendance using a tiered system of support approach. Resources will be shared to support curriculum leaders in fostering student success through improved attendance practices.

Champagne Room

SDI Session: Tier 1 Instruction (Part 2)

Facilitator: Shelly Coburn

This session will explore strategies for sustaining high-quality Tier 1 instructional frameworks to ensure learning for all students. Participants will learn about the essential components of Tier 1 instruction, challenges in maintaining consistency, and actionable solutions such as ongoing professional development, fostering collaboration, and leveraging data-driven decision-making. The session will provide practical tools for planning, monitoring, and celebrating the success of sustained instructional practices.